

NEW WINTERBORO HIGH SCHOOL

PACKAGE B: BUILDING CONSTRUCTION

22445 COUNTY ROAD 21 ALPINE, ALABAMA 35014

TALLADEGA COUNTY BOARD OF EDUCATION

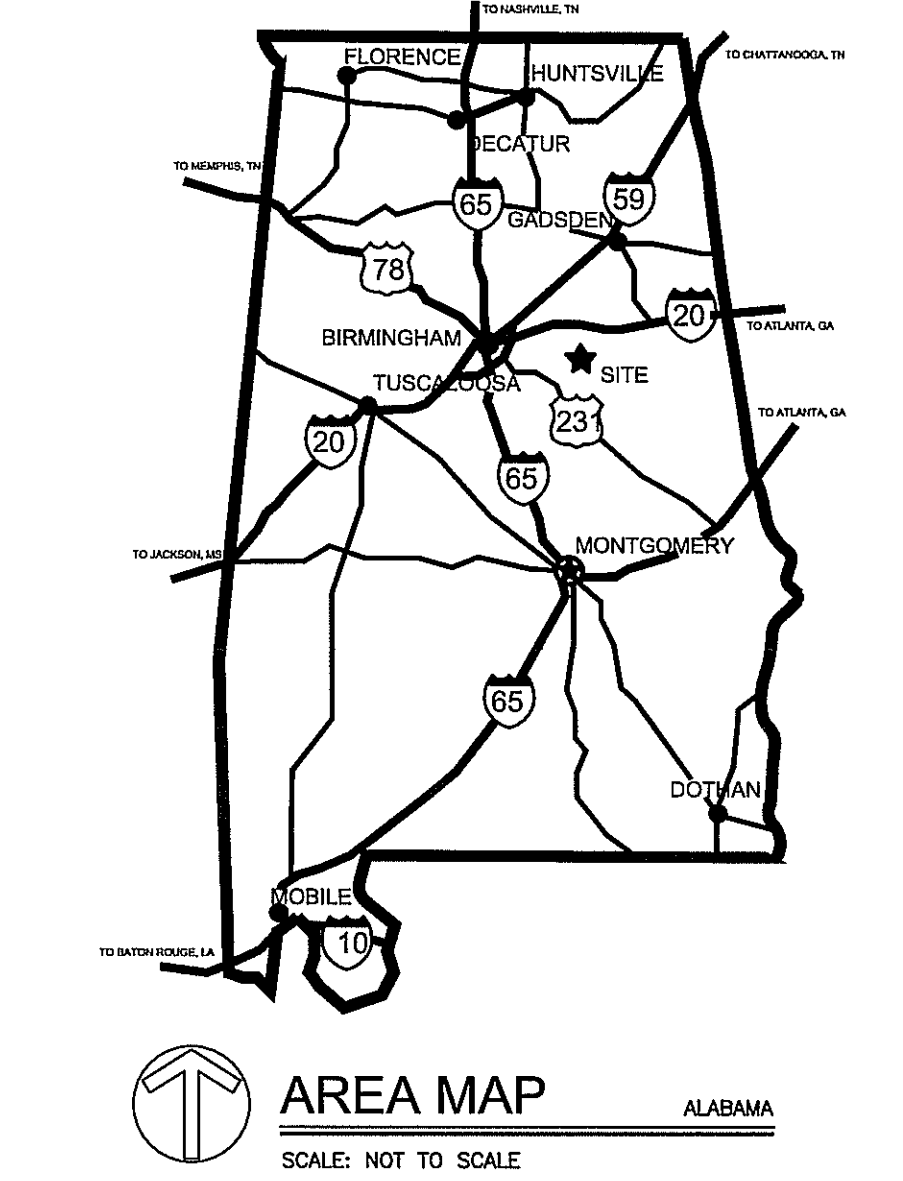
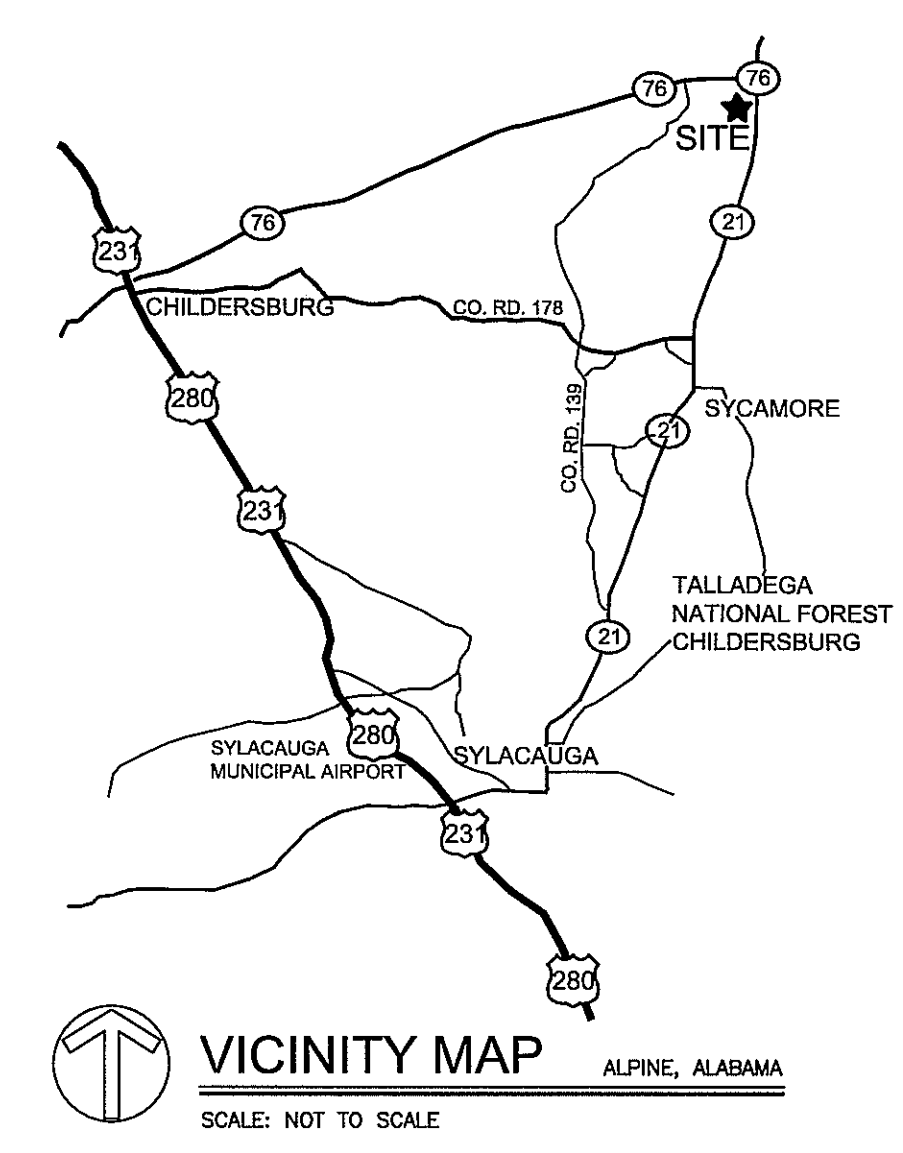

LATHAN ASSOCIATES ARCHITECTS, P.C.
1550 WOODS OF RIVERCHASE DRIVE
SUITE 200 - HOOPER, ALABAMA 35244
PH. 205-988-9112 - FAX 205-988-9196

NEW WINTERBORO HIGH SCHOOL
PACKAGE B: BUILDING CONSTRUCTION
22445 COUNTY ROAD 21 ALPINE, ALABAMA 35014
TALLADEGA COUNTY BOARD OF EDUCATION

KATHY LANDERS	CHAIRMAN	OWNER - TALLADEGA COUNTY BOARD OF ED.	ARCHITECT - LATHAN ASSOCIATES ARCHITECTS, P.C.	PLUMBING / MECHANICAL ENGINEER - WHORTON ENGINEERING, INC.
JOAN DOYLE	VICE-CHAIRMAN	106 W. SOUTH STREET POST OFFICE BOX 887 TALLADEGA, ALABAMA 35161-0887	1550 WOODS OF RIVERCHASE DRIVE ANNISTON, ALABAMA 35244 205-988-9112	PO BOX 5190 ANNISTON, ALABAMA 36205 256-820-9897
JOHN PONDER	MEMBER		CONTACT: W. LEE BRYANT, AIA	CONTACT: HEATHER PAGE
SANDRA TUCK	MEMBER			
MIKE TURNER	MEMBER			
DR. SUZANNE LACEY	SUPERINTENDENT	CIVIL ENGINEER - LBYD, INC.	STRUCTURAL ENGINEER - LBYD, INC.	ELECTRICAL ENGINEER - STEWART ENGINEERING
KELVIN CUNNINGHAM	DIRECTOR OF OPERATIONS	716 SOUTH 30TH STREET BIRMINGHAM, ALABAMA 35233 205-251-4500	716 SOUTH 30TH STREET BIRMINGHAM, ALABAMA 35233 205-251-4500	PO BOX 2233 ANNISTON, ALABAMA 36202 256-237-0891
		CONTACT: CHRIS HARKINS, P.E.	CONTACT: TOM HADZOR	CONTACT: SHAWN CRAWFORD

DRAWING INDEX - VOLUME 1 OF 2

VOLUME ONE - BUILDING PACKAGE 17-06B

DRAWING INDEX - VOLUME 2 OF 2

1/247	T1.0	- TITLE AND INDEX - VOLUME ONE
REFERENCE DRAWINGS		
2/247	S1	- TOPOGRAPHIC SURVEY (FOR REFERENCE ONLY)
CIVIL DRAWINGS		
3/247	C0.1	- CIVIL NOTES
4/247	C1.0	- SITE LAYOUT PLAN - NORTH
5/247	C1.1	- SITE LAYOUT PLAN - SOUTH
6/247	C2.0	- GRADING & DRAINAGE PLAN - NORTH
7/247	C2.1	- GRADING & DRAINAGE PLAN - SOUTH
8/247	C3.0	- EROSION CONTROL PLAN - NORTH
9/247	C3.1	- EROSION CONTROL PLAN - SOUTH
10/247	C4.0	- UTILITY PLAN - NORTH
11/247	C4.1	- UTILITY PLAN - SOUTH
12/247	C4.2	- OVERALL SITE PLAN SCOPE OF WORK
13/247	C4.3	- LAGOON BASINS SITE PLAN
14/247	C4.4	- LAGOON BASIN #2 PLAN
15/247	C4.5	- LAGOON BASIN #2 SECTIONS
16/247	C4.6	- BLOWER AND PUMP DETAILS
17/247	C4.7	- LAGOON BASIN AND ELECTRICAL DETAILS
18/247	C4.8	- NOTES AND SPECIFICATIONS
19/247	C5.0	- NORTHERN DRIVE PLANS
20/247	C6.0	- ALDOT IMPROVEMENTS: EXISTING CONDITIONS & DEMOLITION PLANS
21/247	C6.1	- ALDOT IMPROVEMENTS: LAYOUT, STRIPING & SIGNAGE, AND TRAFFIC CONTROL PLANS
22/247	C6.2	- ALDOT IMPROVEMENTS: HIGHWAY 21 PLAN & PROFILE
23/247	C6.3	- ALDOT IMPROVEMENTS: GRADING & DRAINAGE, AND EROSION CONTROL PLANS
24/247	C6.4	- ALDOT IMPROVEMENT PLANS: TYPICAL SECTIONS
25/247	C6.5	- ALDOT IMPROVEMENT PLANS: CROSS SECTIONS 0+00 - 2+00
26/247	C6.6	- ALDOT IMPROVEMENT PLANS: CROSS SECTIONS 2+50 - 4+50
27/247	C6.7	- ALDOT IMPROVEMENT PLANS: CROSS SECTIONS 5+00 - 7+00
28/247	C6.8	- ALDOT IMPROVEMENT PLANS: CROSS SECTIONS 7+50 - 9+50
29/247	C6.9	- ALDOT IMPROVEMENT PLANS: CROSS SECTIONS 10+00 - 12+00
30/247	C6.10	- ALDOT IMPROVEMENT PLANS: CROSS SECTIONS 12+50 - 13+99.26
31/247	C6.11	- ALDOT IMPROVEMENT PLANS: TRAFFIC CONTROL NOTES
32/247	C6.12	- ALDOT IMPROVEMENT PLANS: TRAFFIC CONTROL PLAN
33/247	C7.0	- CIVIL DETAILS
34/247	C7.1	- EROSION CONTROL DETAILS
ARCHITECTURAL DRAWINGS		
35/247	A1.1	- OVERALL MAIN FLOOR PLAN
36/247	A1.2	- OVERALL ATTIC PLAN
37/247	A1.3.0	- ROOF PLAN AND NOTES
38/247	A1.3.1	- TYPICAL ROOF DETAILS
39/247	A1.3.2	- ROOF DETAILS
40/247	A1.3.3	- ROOF DETAILS
41/247	A1.3.4	- ROOF DETAILS
42/247	A1.3.5	- ROOF DETAILS
43/247	A1.4	- LIFE SAFETY PLAN
44/247	A1.5	- TORNADO STORM SHELTER PLAN, LEGENDS & DETAILS
45/247	A2.1	- PARTIAL FLOOR PLAN - AREA A
46/247	A2.2	- PARTIAL FLOOR PLAN - AREA B
47/247	A2.3	- PARTIAL FLOOR PLAN - AREA C

48/247	A2.4	- PARTIAL FLOOR PLAN - AREA D
49/247	A2.5	- PARTIAL FLOOR PLAN - AREA E
50/247	A2.6	- PARTIAL ATTIC PLAN - AREA A
51/247	A2.7	- PARTIAL ATTIC PLAN - AREA B
52/247	A2.8	- PARTIAL ATTIC PLAN - AREA C
53/247	A2.9	- DOOR SCHEDULE AND DETAILS
54/247	A2.10	- WINDOW SCHEDULE AND DETAILS
55/247	A2.11	- WINDOW SCHEDULE AND DETAILS
56/247	A2.12	- CANOPY PLAN, ELEVATIONS, AND DETAILS
57/247	A2.13	- CANOPY PLAN, ELEVATIONS, AND DETAILS
58/247	A2.14	- CANOPY ELEVATIONS, AND DETAILS
59/247	A2.15	- DUMPSTER PLAN, SECTIONS, ELEVATIONS, AND DETAILS
60/247	A2.16	- ENLARGED PLAN DETAILS
61/247	A2.17	- ENLARGED PLAN DETAILS
62/247	A3.1.1	- ELEVATIONS
63/247	A3.2.1	- SECTION / ELEVATIONS
64/247	A3.2.2	- SECTION / ELEVATIONS
65/247	A3.2.3	- SECTIONS
66/247	A3.2.4	- SECTIONS
67/247	A3.2.5	- SECTIONS
68/247	A3.3.1	- WALL SECTIONS
69/247	A3.3.2	- WALL SECTIONS
70/247	A3.3.3	- WALL SECTIONS
71/247	A3.3.4	- WALL SECTIONS
72/247	A3.3.5	- WALL SECTIONS
73/247	A3.3.6	- WALL SECTIONS
74/247	A3.3.7	- WALL SECTIONS
75/247	A3.3.8	- WALL SECTIONS
76/247	A3.3.9	- WALL SECTIONS
77/247	A3.3.10	- WALL SECTIONS
78/247	A3.3.11	- WALL SECTIONS
79/247	A3.3.12	- WALL SECTIONS
80/247	A3.4.1	- ENLARGED ELEVATION AND DETAILS
81/247	A3.4.2	- ENLARGED ELEVATION AND DETAILS
82/247	A3.4.3	- ENLARGED ELEVATION AND DETAILS
83/247	A3.4.4	- ENLARGED ELEVATION AND DETAILS
84/247	A4.1	- ENLARGED TOILET PLANS
85/247	A4.2	- TOILET ELEVATIONS
86/247	A4.3	- TOILET DETAILS & TYPICAL ADA MOUNTING HEIGHTS
87/247	A5.1	- PARTIAL CASEWORK/MILLWORK PLAN - AREA "A" AND RECEPTION DESK ELEVATIONS
88/247	A5.2	- PARTIAL MILLWORK/CASEWORK PLAN - AREA "B" AND MEDIA CENTER CIRCULATION DESK ELEVATIONS
89/247	A5.3	- PARTIAL MILLWORK/CASEWORK PLAN - AREA "C"
90/247	A5.4	- PARTIAL MILLWORK/CASEWORK PLAN - AREA "D"
91/247	A5.5	- PARTIAL MILLWORK/CASEWORK PLAN - AREA "E"
92/247	A5.6	- INTERIOR ELEVATIONS
93/247	A5.7	- INTERIOR ELEVATIONS
94/247	A5.8	- INTERIOR ELEVATIONS
95/247	A5.9	- INTERIOR ELEVATIONS
96/247	A5.10	- INTERIOR ELEVATIONS
97/247	A5.11	- MILLWORK SECTIONS
98/247	A5.12	- MILLWORK SECTIONS
99/247	A5.13	- MILLWORK SECTIONS
100/247	A6.1	- PARTIAL REFLECTED CEILING PLAN - AREA "A"
101/247	A6.2	- PARTIAL REFLECTED CEILING PLAN - AREA "B"
102/247	A6.3	- PARTIAL REFLECTED CEILING PLAN - AREA "C"
103/247	A6.4	- PARTIAL REFLECTED CEILING PLAN - AREA "D"
104/247	A6.5	- PARTIAL REFLECTED CEILING PLAN - AREA "E"
105/247	A6.6	- PARTIAL ATTIC REFLECTED CEILING PLAN - AREA A
106/247	A6.7	- PARTIAL ATTIC REFLECTED CEILING PLAN - AREA B
107/247	A6.8	- PARTIAL ATTIC REFLECTED CEILING PLAN - AREA C
108/247	A6.9	- CEILING DETAILS
109/247	A7.1	- STAIR AND RAMP ENLARGED PLANS, SECTIONS AND DETAILS
110/247	A7.2	- STAIR AND RAMP ENLARGED PLANS, SECTIONS AND DETAILS
111/247	A8.1	- PARTIAL FINISH FLOOR PLAN - AREA A
112/247	A8.2	- PARTIAL FINISH FLOOR PLAN - AREA B
113/247	A8.3	- PARTIAL FINISH FLOOR PLAN - AREA C
114/247	A8.4	- PARTIAL FINISH FLOOR PLAN - AREA D
115/247	A8.5	- PARTIAL FINISH FLOOR PLAN - AREA E AND FLOOR TRANSITION DETAILS
116/247	A8.6	- FINISH SCHEDULE
117/247	A9.1	- ENLARGED FOODSERVICE FLOOR PLAN
118/247	A9.2	- EQUIPMENT LIST & SCHEDULE OF CONNECTIONS
119/247	A9.3	- FOODSERVICE PLUMBING ROUGH-IN PLAN
120/247	A9.4	- FOODSERVICE ELECTRICAL ROUGH-IN PLAN
121/247	A9.5	- FOODSERVICE SPECIAL CONDITIONS PLAN
122/247	A9.6	- FOODSERVICE EQUIPMENT ELEVATIONS
STRUCTURAL DRAWINGS		
123/247	S1.1	- ABBREVIATIONS AND GENERAL NOTES
124/247	S1.2	- GENERAL NOTES (CONT.) AND SYMBOLS LEGEND
125/247	S1.3	- TYPICAL DETAILS
126/247	S1.4	- TYPICAL DETAILS
127/247	S1.5	- TYPICAL DETAILS
128/247	S1.6	- TYPICAL DETAILS
129/247	S1.7	- COMPONENTS AND CLADDING WIND PRESSURES
130/247	S1.8	- SPECIAL INSPECTIONS
131/247	S2.1	- FOUNDATION AND FLOOR PLAN - AREA A
132/247	S2.2	- FOUNDATION AND FLOOR PLAN - AREA B
133/247	S2.3	- FOUNDATION AND FLOOR PLAN - AREA C
134/247	S2.4	- FOUNDATION AND FLOOR PLAN - AREA D
135/247	S2.5	- FOUNDATION AND FLOOR PLAN - AREA E
136/247	S2.6	- ATTIC FRAMING PLAN - AREA A
137/247	S2.7	- ATTIC FRAMING PLAN - AREA B
138/247	S2.8	- ATTIC FRAMING PLAN - AREA C
139/247	S2.9	- ROOF FRAMING PLAN - AREA A
140/247	S2.10	- ROOF FRAMING PLAN - AREA B
141/247	S2.11	- ROOF FRAMING PLAN - AREA C
142/247	S2.12	- ROOF FRAMING PLAN - AREA D
143/247	S2.13	- ROOF FRAMING PLAN - AREA E
144/247	S3.1.1	- FOUNDATION SECTIONS
145/247	S3.1.2	- FOUNDATION SECTIONS
146/247	S3.1.3	- FRAMING SECTIONS
147/247	S3.1.4	- FRAMING SECTIONS
148/247	S3.1.5	- FRAMING SECTIONS
149/247	S3.1.6	- FRAMING SECTIONS
150/247	S3.1.7	- FRAMING SECTIONS
151/247	S4.1.1	- ELEVATIONS
152/247	S4.1.2	- ELEVATIONS

153/247	T2.0	- TITLE AND INDEX - VOLUME TWO
PLUMBING DRAWINGS		
154/247	P1.1	- PLUMBING SITE
155/247	P2.1	- PLUMBING SCHEDULES
156/247	P2.2	- PLUMBING DETAILS
157/247	P3.1	- WASTE & CONDENSATE PLUMBING PLAN - PART "A"
158/247	P3.2	- WASTE & CONDENSATE PLUMBING PLAN - PART "B"
159/247	P3.3	- WASTE & CONDENSATE PLUMBING PLAN - PART "C"
160/247	P3.4	- WASTE & CONDENSATE PLUMBING PLAN - PART "D"
161/247	P3.5	- WASTE & CONDENSATE PLUMBING PLAN - PART "E"
162/247	P3.6	- ROOF LEVEL STORM DRAIN & CONDENSATE PLUMBING PLAN - PART "E"
163/247	P4.1	- ATTIC PLUMBING PLAN - PART "A"
164/247	P4.2	- ATTIC PLUMBING PLAN - PART "B"
165/247	P4.3	- ATTIC PLUMBING PLAN - PART "C"
166/247	P5.1	- WATER & GAS PLUMBING PLAN - PART "A"
167/247	P5.2	- WATER & GAS PLUMBING PLAN - PART "B"
168/247	P5.3	- WATER & GAS PLUMBING PLAN - PART "C"
169/247	P5.4	- WATER & GAS PLUMBING PLAN - PART "D"
170/247	P5.5	- WATER & GAS PLUMBING PLAN - PART "E"
171/247	P6.1	- PLUMBING PLAN - STORM SHELTER
172/247	P7.1	- WASTE PLUMBING RISER DIAGRAMS
173/247	P7.2	- WASTE PLUMBING RISER DIAGRAMS
174/247	P7.3	- WASTE PLUMBING RISER DIAGRAMS
175/247	P7.4	- WASTE PLUMBING RISER DIAGRAMS
176/247	P7.5	- WATER PLUMBING RISER DIAGRAMS
177/247	P7.6	- WATER PLUMBING RISER DIAGRAMS
178/247	P7.7	- WATER PLUMBING RISER DIAGRAMS
179/247	P7.8	- WATER PLUMBING RISER DIAGRAMS
180/247	P7.9	- WATER PLUMBING RISER DIAGRAMS
181/247	P7.10	- GAS PLUMBING RISER DIAGRAMS
182/247	SP1.1	- FIRE SPRINKLER PLUMBING LEGEND, NOTES, AND DETAILS
183/247	SP2.1	- FIRE SPRINKLER PLUMBING PLAN
184/247	SP2.2	- FIRE SPRINKLER PLUMBING PLAN - ATTIC
185/247	SP3.1	- FIRE SPRINKLER PLUMBING PLAN - STORM SHELTER
MECHANICAL DRAWINGS		
186/247	M1.1	- HVAC LEGEND AND NOTES
187/247	M1.2	- HVAC SCHEDULES PART "A"
188/247	M1.3	- HVAC SCHEDULES PART "A"
189/247	M1.4	- HVAC SCHEDULES PART "B"
190/247	M1.5	- HVAC SCHEDULES PART "B"
191/247	M1.6	- HVAC SCHEDULES PART "B" - SHELTER
192/247	M1.7	- HVAC SCHEDULES PART "C"
193/247	M1.8	- HVAC SCHEDULES PART "C"
194/247	M1.9	- HVAC SCHEDULES PART "D"
195/247	M1.10	- HVAC SCHEDULES PART "D" AND PART "E"
196/247	M1.11	- HVAC SCHEDULES PART "E"
197/247	M2.1	- HVAC DETAILS
198/247	M2.2	- HVAC DETAILS
199/247	M2.3	- HVAC DETAILS
200/247	M2.4	- HVAC IAQ CALCULATIONS

201/247	M2.5	- HVAC IAQ CALCULATIONS
202/247	M2.6	- HVAC IAQ CALCULATIONS
203/247	M2.7	- HVAC IAQ AND COMPLIANCE CALCULATIONS
204/247	M2.8	- HVAC COMPLIANCE CALCULATIONS
205/247	M2.9	- HVAC VARIABLE REFRIGERANT FLOW DIAGRAM
206/247	M2.10	- HVAC VARIABLE REFRIGERANT FLOW DIAGRAM
207/247	M3.1	- HVAC PLAN - PART "A"
208/247	M3.2	- HVAC PLAN - PART "B"
209/247	M3.3	- HVAC PLAN - PART "C"
210/247	M3.4	- HVAC PLAN - PART "D"
211/247	M3.5	- HVAC PLAN - PART "E"
212/247	M3.6	- HVAC PLAN - SHELTER AREA
213/247	M4.1	- OUTSIDE AIR / EXHAUST PLAN - PART "A"
214/247	M4.2	- OUTSIDE AIR / EXHAUST PLAN - PART "B"
215/247	M4.3	- OUTSIDE AIR / EXHAUST PLAN - PART "C"
216/247	M4.4	- OUTSIDE AIR / EXHAUST PLAN - PART "D"
ELECTRICAL DRAWINGS		
217/247	E1.1	- SCHEDULES, SYMBOLS, AND NOTES
218/247	E1.2	- SCHEDULES AND DETAILS
219/247	E1.3	- SINGLE LINE DIAGRAMS
220/247	E2.1	- SITE PLAN AND DETAILS
221/247	E2.2	- LIGHTING CONTROL PLAN
222/247	E3.1.1	- PARTIAL FLOOR PLAN AREA A - LIGHTING
223/247	E3.1.2	- PARTIAL FLOOR PLAN AREA B - LIGHTING
224/247	E3.1.3	- PARTIAL FLOOR PLAN AREA C - LIGHTING
225/247	E3.1.4	- PARTIAL FLOOR PLAN AREA D - LIGHTING
226/247	E3.1.5	- PARTIAL FLOOR PLAN AREA E - LIGHTING
227/247	E3.2.1	- PARTIAL ATTIC PLAN AREA A - LIGHTING
228/247	E3.2.2	- PARTIAL ATTIC PLAN AREA B - LIGHTING
229/247	E3.2.3	- PARTIAL ATTIC PLAN AREA C - LIGHTING
230/247	E3.3	- CANOPY PLANS - LIGHTING
231/247	E4.1.1	- PARTIAL FLOOR PLAN AREA A - POWER
232/247	E4.1.2	- PARTIAL FLOOR PLAN AREA B - POWER
233/247	E4.1.3	- PARTIAL FLOOR PLAN AREA C - POWER
234/247	E4.1.4	- PARTIAL FLOOR PLAN AREA D - POWER
235/247	E4.1.4A	- ENLARGED KITCHEN PLAN - POWER
236/247	E4.1.5	- PARTIAL FLOOR PLAN AREA E - POWER
237/247	E4.2.1	- PARTIAL ATTIC PLAN AREA A - POWER
238/247	E4.2.2	- PARTIAL ATTIC PLAN AREA B - POWER
239/247	E4.2.3	- PARTIAL ATTIC PLAN AREA C - POWER
240/247	E5.1.1	- PARTIAL FLOOR PLAN AREA A - AUXILIARIES
241/247	E5.1.2	- PARTIAL FLOOR PLAN AREA B - AUXILIARIES

TOPOGRAPHIC SURVEY
WINTERBORO HIGH SCHOOL
 22601 AL. HWY. 21
 ALPINE, ALABAMA 35014

PREPARED FOR:
TALLADEGA COUNTY SCHOOLS
 105 WEST SOUTH STREET
 TALLADEGA, ALABAMA 35180
 256-315-5100

WEST HALF OF SECTION 2, TOWNSHIP 20 SOUTH,
 RANGE 4 EAST, TALLADEGA COUNTY, ALABAMA

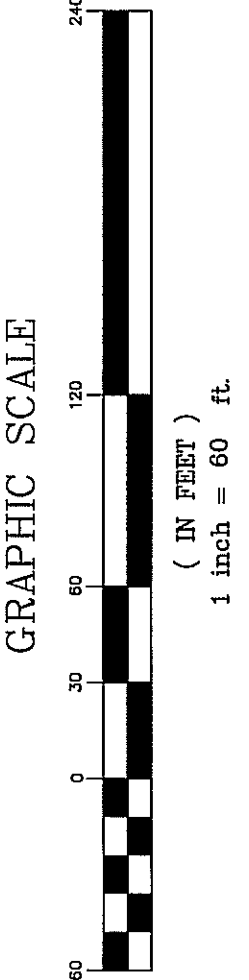

LEGEND			
○	UTILITY POLE	—	FINISH FLOOR ELEVATION
○	ELCOO LIGHT	—	REINFORCED CONCRETE PIPE
—	GUY WIRE	—	CORRUGATED METAL PIPE
□	ELECTRIC BOX	—	CORRUGATED PLASTIC PIPE
□	FIRE HYDRANT	—	OVERHEAD ELECTRIC
□	WATER VALVE	—	UNDERGROUND ELECTRIC
□	TELEPHONE PEDESTAL	—	TELEPHONE LINE
□	TELEPHONE MARKER	—	FIBER OPTIC LINE
□	FIBER OPTIC MARKER	—	CHAIN LINK FENCE
□	GAS METER	—	GUARD RAIL
□	STORM MANHOLE	—	WALL
□	GRATE INLET	—	ASPHALT
□	DOWNSPOUT	—	CONCRETE
□	SANITARY MANHOLE	—	GRAVEL
□	CLEANOUT	—	
□	MAILBOX	—	
□	STEP COUNT	—	
□	SATELLITE DISH	—	

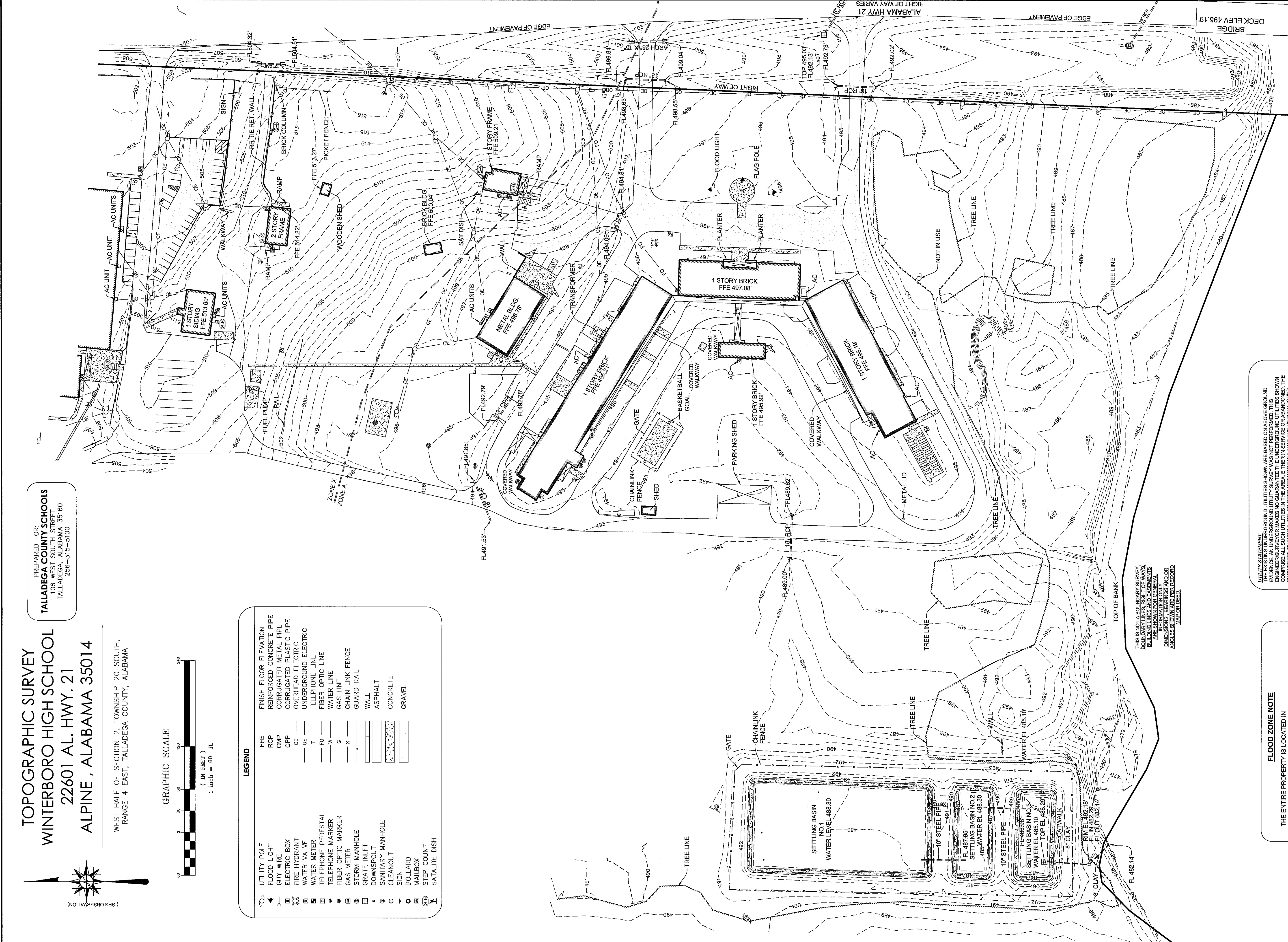

THE FLOOD ZONE
 ALL BEARINGS AND/OR ANGLES, AND DISTANCES ARE DEED AND ACTUAL UNLESS OTHERWISE NOTED.
 1. ALL BEARINGS AND/OR ANGLES, AND DISTANCES ARE DEED AND ACTUAL UNLESS OTHERWISE NOTED.
 2. STRUCTURES WERE NOT LOCATED UNLESS OTHERWISE NOTED.
 3. THIS SURVEY IS VALID ONLY WITH AN ORIGINAL SIGNATURE AND A LEGIBLE SEAL.

FLOOD ZONE NOTE
 THE ENTIRE PROPERTY IS LOCATED IN ZONE X. UNSHADED (AREAS DETERMINED TO BE OUTSIDE THE 0.2% ANNUAL CHANCE FLOODPLAIN). ZONE X HAS AN ANNUAL FLOOD ELEVATION DETERMINED BY THE FEDERAL FLOOD INSURANCE PROGRAM (FFIP) MAP # 01121C0338E PANEL 393 OF 650 MAP EFFECTIVE DATE SEPT. 28, 2007.

SURVEY CONTROL
 THE BASIS OF BEARINGS AND OR DISTANCES ARE THE DEEDS. THE AREAS BASED ON ALABAMA STATE PLANE EAST ZONE, GRID NORTH, NAD 83 (2011) AND VERTICAL DATUM IS NAVD 83 (GEOID 1981) ELEVATION DATA. THE SURVEY WAS CONDUCTED BY OBSERVATION USING THE ALDOT CORS NETWORK AS CONTROL.

811
 Know what's below.
 Call before you dig.
 Call 2 working days before digging.
 It's the Law!

ARRINGTON ENGINEERING - Surveyors - Land Planners
 Civil Engineers - Surveyors - Land Planners
 Office: (205) 992-9595
 2032 Valleydale Road
 Birmingham, AL 35244

TOPOGRAPHIC SURVEY
 WINTERBORO HIGH SCHOOL
 LOCATION & DESCRIPTION
 WEST HALF OF SECTION 2, TOWNSHIP 20 SOUTH,
 RANGE 4 EAST, TALLADEGA COUNTY, ALABAMA

DRAWING TITLE: TOPOGRAPHIC SURVEY
 WINTERBORO HIGH SCHOOL
 LOCATION & DESCRIPTION
 WEST HALF OF SECTION 2, TOWNSHIP 20 SOUTH,
 RANGE 4 EAST, TALLADEGA COUNTY, ALABAMA

DRAWN BY: JDA, SAE
 CHECKED BY: JDA
 DATE: 2-14-2017
 SCALE: 1"=80'
 PARTY CHIEF: YRA
 PROJECT NO.: 6862
 SHEET: 1 OF 1